

BANQUET & CONVENTION
FACILITIES



 *PORTOPIA HOTEL*

KOBE, JAPAN

Main Building

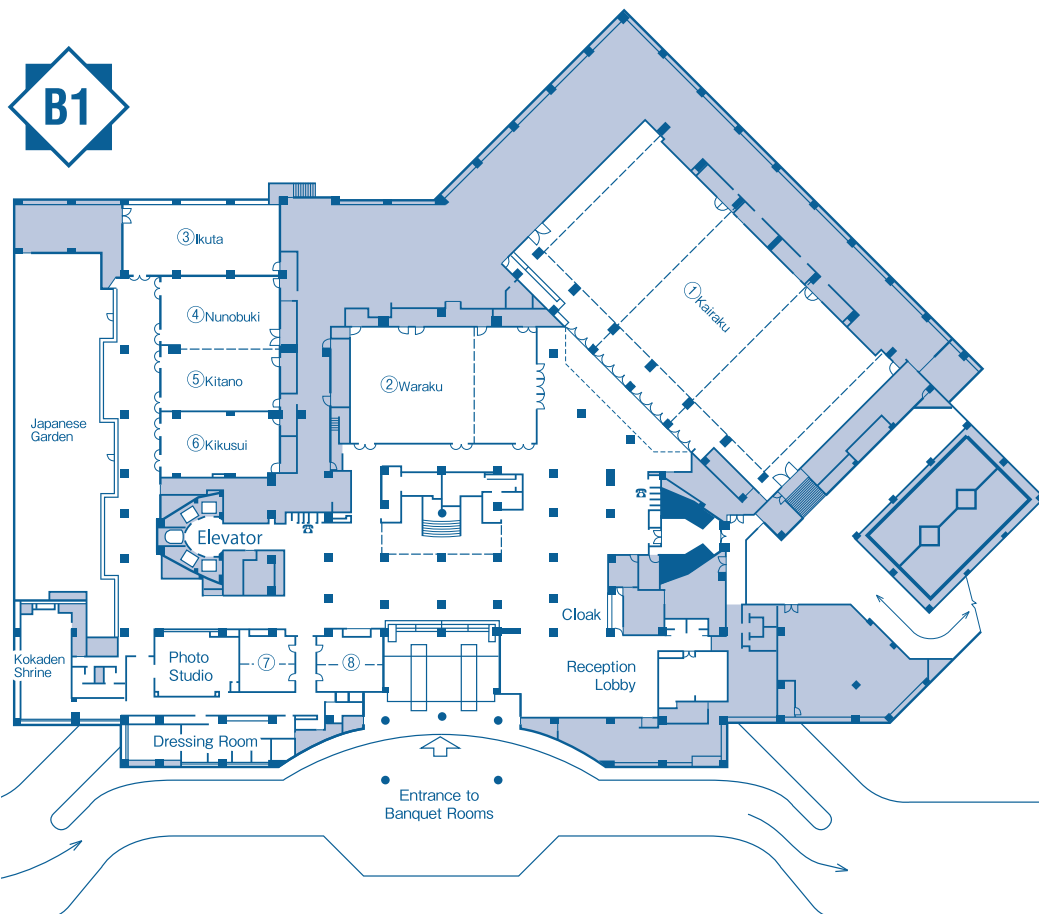
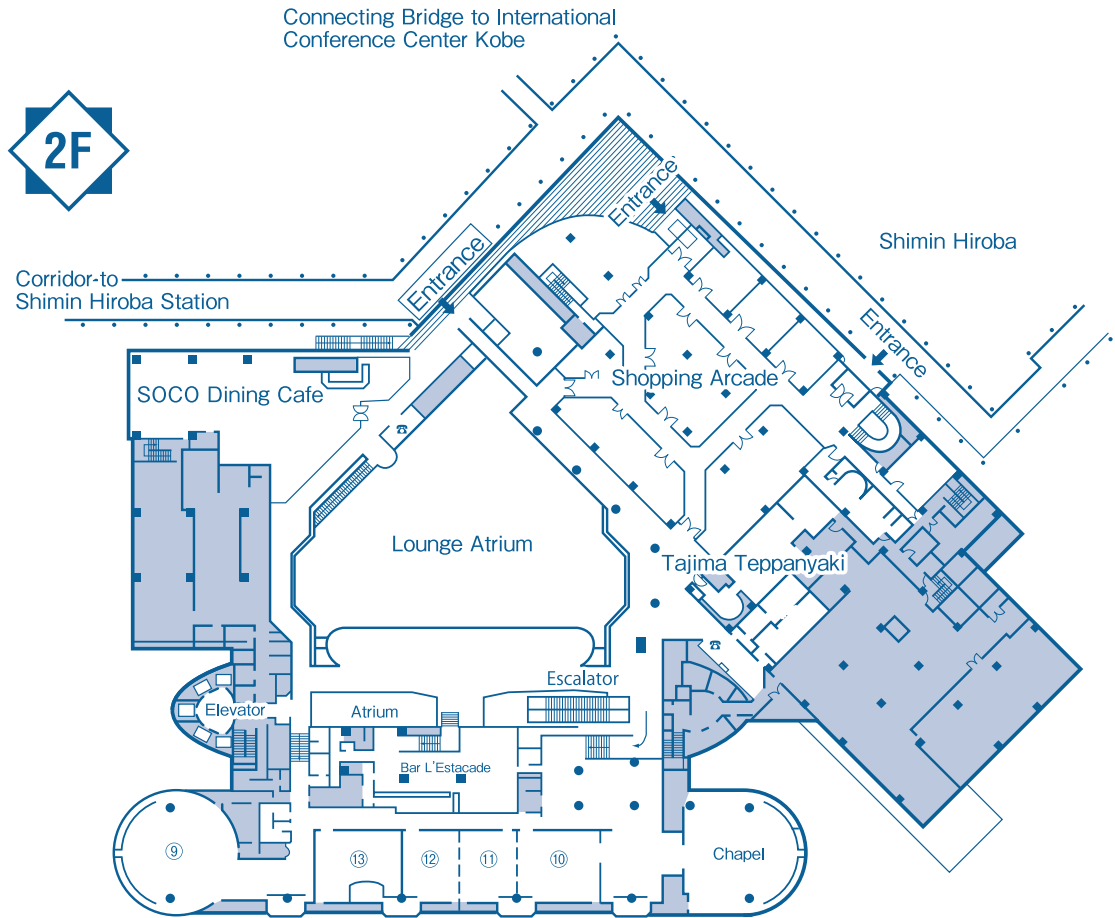

South Wing

3F

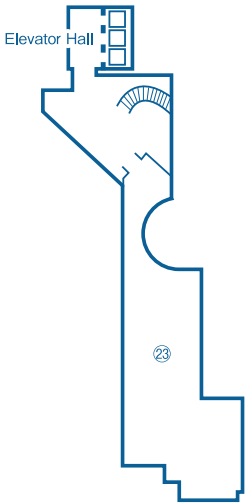

4F

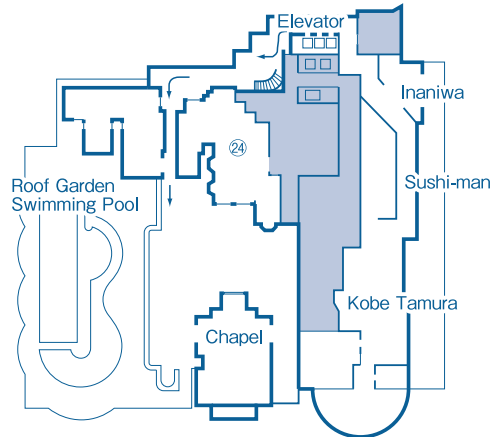

5F

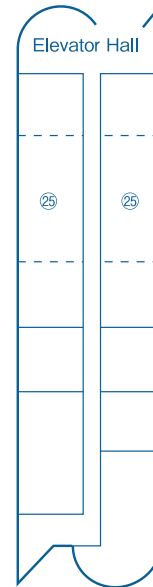

16F

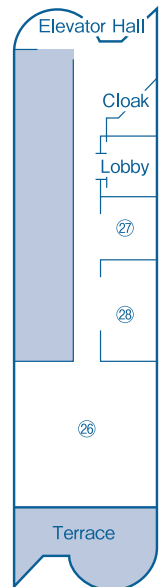

1F

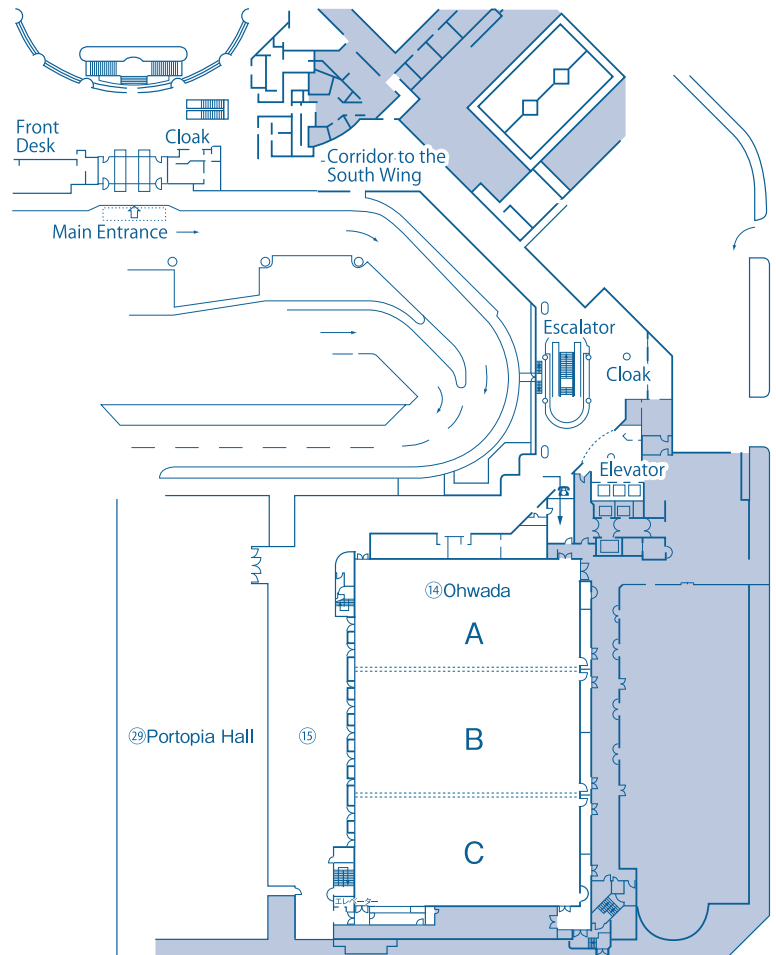

B1

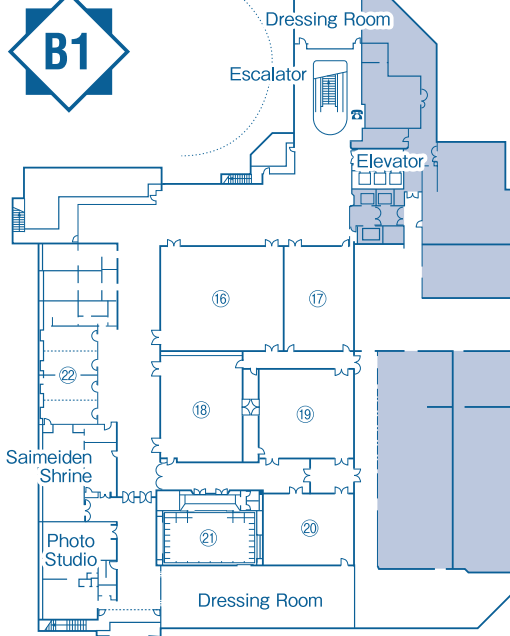

BANQUET ROOMS

ROOM NAME			AREA / DIMENSIONS					CAPACITY				
			m ²	ft ²	Width (m)	Depth (m)	Height (m)	Dinner	Cocktail Reception	Classroom (Chairs, Tables)	Theater (Chairs Only)	
Main Building	B1F	①Kairaku	1,190	12,804	46.5	25.7	7.0	800	1,200	800	1,200	
			2/3	793	8,533	30.2	25.7	7.0	500	800	560	800
			1/3	397	4,272	16.2	25.7	7.0	230	300	240	400
		②Waraku		377	4,057	24.5	15.2	2.85	230	300	280	400
			2/3	251	2,701	18.3	15.2	2.85	160	200	190	260
			1/3	126	1,356	8.1	15.2	2.85	80	80	80	120
		③Ikuta		188	2,023	20.7	9.0	2.9	120	150	130	200
			④Nunobiki	149	1,603	9.4	15.4	2.9	80	100	110	150
			⑤Kitano	126	1,356	7.9	15.4	2.9	80	80	90	140
		⑥Kikusui		126	1,356	8.4	15.4	2.9	80	80	90	140
			⑦Ume, Sakura	26	280	3.5	7.0	2.6	12	—	*Boardroom style for 16	
			⑧Matsu, Take	30	323	3.5	8.4	2.6	16	—	*Boardroom style for 12	
		2F	⑨Cosmopolitan Room	198	2,130	15.0	—	2.6	—	80	—	—
			⑩Nojigiku	99	1,065	11.1	9.0	2.9	—	—	55	95
			⑪Sumire	66	710	7.3	9.0	2.9	—	—	35	55
	⑫Tsutsuji		66	710	7.3	9.0	2.9	—	—	35	55	
	⑬Salon de Savoir		99	1,065	11.0	9.0	2.9	—	—	—	70	
South Wing	1F	⑭⑮Ohwada w/Foyer	2,607	28,051	—	—	—	—	3,800	—	—	
		⑭Ohwada	2,003	21,552	55.65	36.0	7.0	1,400	3,000	1,650	2,800	
			AB or BC	1,343	14,451	37.325	36.0	7.0	950	1,900	1,100	1,800
			A or C	630	6,779	17.525	36.0	7.0	400	700	550	900
			B	684	7,360	19	36.0	7.0	500	800	550	900
		⑮Ohwada Foyer	604	6,499	12	49.3	3.0	—	—	—	—	
	B1F	⑯Topaz	325	3,497	19.6	16.6	3.0	230	270	250	400	
		⑰Sapphire	184	1,980	11.1	16.6	3.0	120	150	150	220	
		⑱Emerald	214	2,303	12.9	16.6	2.7	140	180	180	280	
		⑲Diamond	215	2,313	14.2	15.2	3.0	150	180	190	300	
		⑳Ruby	167	1,797	11.3	14.8	3.0	110	150	120	200	
		㉑Seto (Japanese Style)	150	1,614	16.7	9.0	3.0	72	—	—	—	
		㉒Rose, Iris, Cattleya, Lilac	30	323	3.5	8.4	2.6	—	—	*Boardroom style for 16		
	3F	Party Space ㉓Keynotes	264	2,841	—	—	—	140	300	—	—	
	4F	Terrace Banquet ㉔Levante	265	2,852	—	—	—	70	70	—	—	
5F	㉕Meeting Rooms	32	344	4.2	7.8	2.6	—	—	*Boardroom style for 12			
16F	Sky Banquet Rooms	㉖Rainbow	362	3,895	18.6	19.5	3.5	200	300	270	400	
		㉗Sylvia	95	1,022	13.1	7.3	3.0	26	—	—	—	
		㉘Selene	63	678	8.65	7.3	3.0	14	—	—	—	

Portopia Hall	Capacity (seats)	1,702 (with small desk)	Stage	Proscenium frontage: 22.5 m (width) x 10 m (depth) x 8 m (height)	
	First floor	1,308 (Theater style)			610 (Classroom style)
	Mezzanine	126			
	Second floor	268			

KOBE'S PREMIER CONVENTION DESTINATION

Main Building & Executive Floors

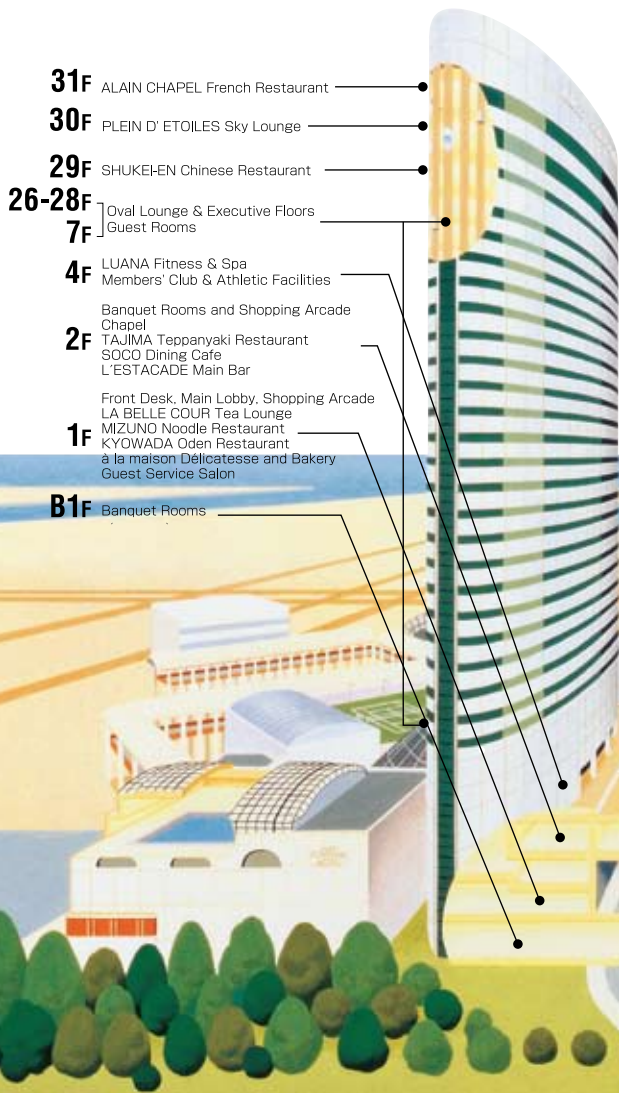

South Wing

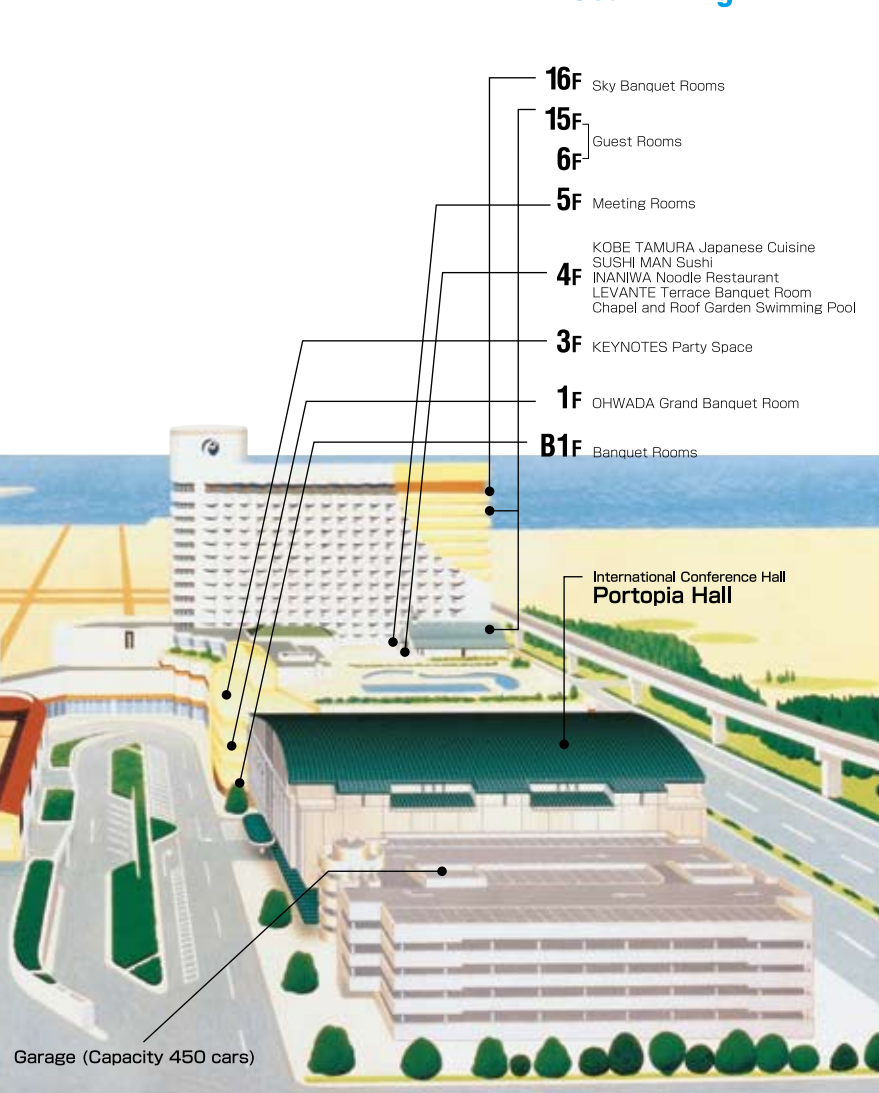

The Portopia Hotel is the landmark of Port Island.

Designed in the image of a luxury ship, the hotel's north rooms offer spectacular views of the Rokko mountains and Kobe's waterfront, while the south rooms overlook the Kobe Airport and Osaka Bay.

The multifunctional Portopia Hall with 1,702 seats, combined with the Portopia Hotel's 36 versatile banquet and meeting rooms, is an ideal venue for international conferences and concert performances.

ACCESS

- Complimentary shuttle bus from the hotel to Sannomiya and JR Shin-Kobe Station
- 10 minutes by Port Liner from Sannomiya Station to Shimin Hiroba Station (next to the hotel)
- 10 minutes by taxi from Sannomiya Station
- 15 minutes by taxi from JR Shin-Kobe Station
- 8 minutes by Port Liner from Kobe Airport
- 50 minutes by taxi from Osaka International (Itami) Airport
- 29 minutes by Kobe-Kanku Bay Shuttle (high speed ferry) from Kansai International Airport Terminal to Kobe Airport Kaijo Access Terminal, then 8 minutes by Port Liner to the hotel
- 30 minutes by bullet train from Kyoto to Shin-Kobe Station, then 20 minutes by hotel shuttle bus

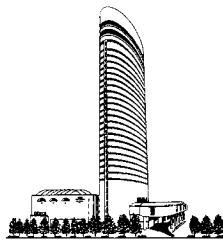
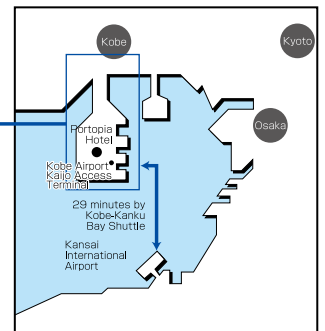
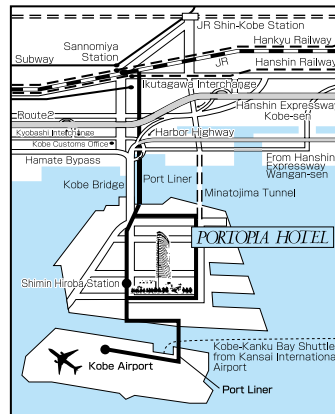

 **PORTOPIA HOTEL**

**10-1, 6 Chome, Minatojima Nakamachi,
Chuo-ku, Kobe 650-0046, Japan**

Tel. (078) 302-1111 Fax (078) 302-6877

Tokyo Office : Tel. (03) 3256-5005 Fax (03) 3256-5205

Osaka Office: Tel. (06) 6203-6800 Fax (06) 6203-6866